

508 E 40th Street

Garden City, Idaho, 83714

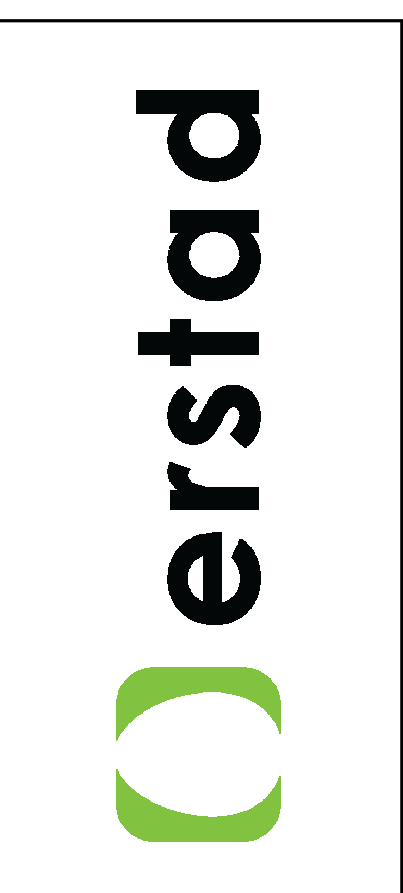
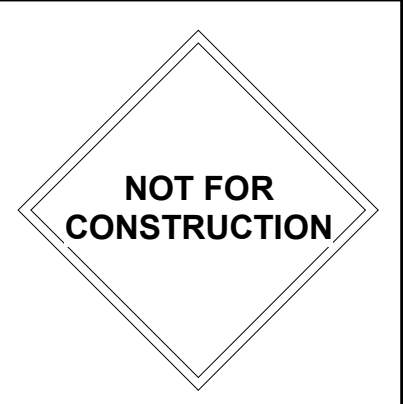

This document is the property of erstad ARCHITECTS and is protected by U.S. and international laws. Use, reproduction, or modification of this document without first obtaining written permission of erstad ARCHITECTS is prohibited. This document may not be used in any unauthorized manner. ©2024

508 E 40th Street
Garden City, Idaho, 83714

revision:		
no.	desc.	date

project: 230309
date: 08.13.2024

CUP / DR

cover sheet
+ site plan
A0.0

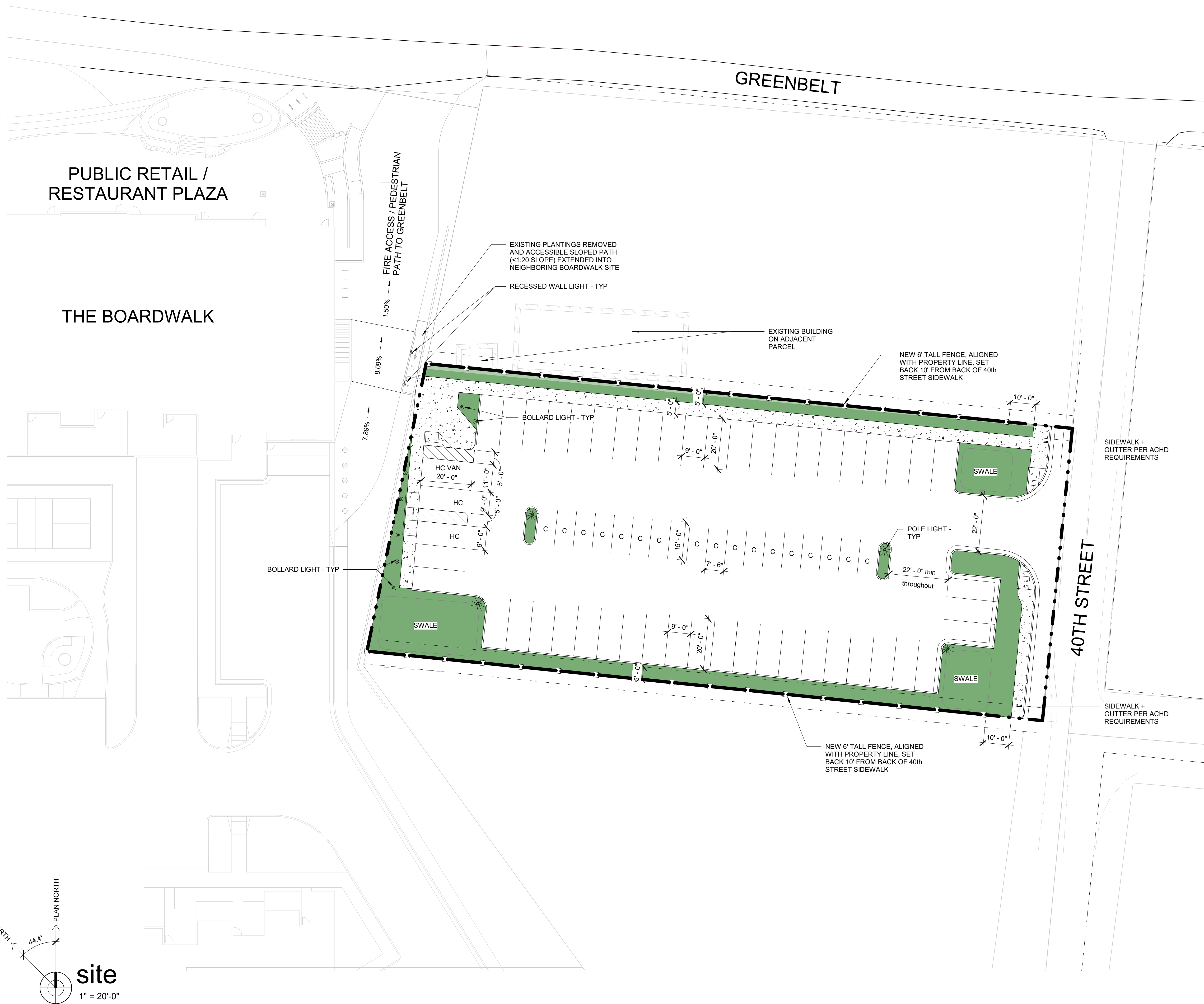

SITE DATA

use: parking
 site zoning: C-2 (General Commercial)
 site size: 0.68 acre site

description: surface parking area for use in conjunction with adjacent retail + greenbelt functions

land use: total site area: 30,265 sf
 impervious area: 24,620 sf 81.35%
 landscape area: 5,645 sf 18.65%

parking: 67 total parking spaces
 3 ada spaces
 46 standard spaces
 18 compact spaces



LIGHTING GENERAL NOTES

- ALL SITE LIGHTING TO BE DIRECTED INTERNALLY. NO LIGHT TO EXTEND ACROSS SHARED PROPERTY LINES

VICINITY MAP

NOT TO SCALE

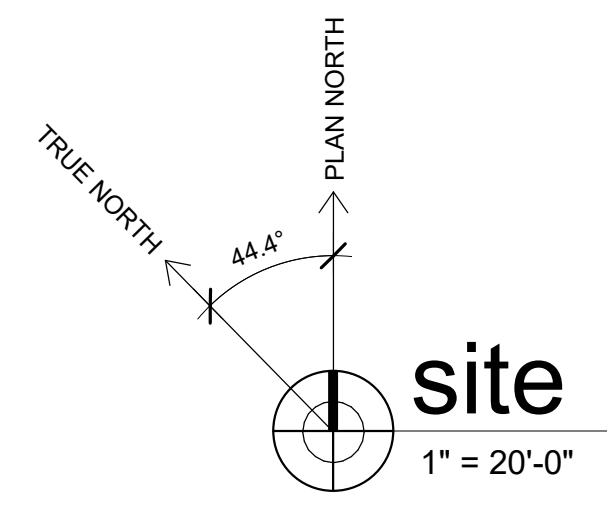
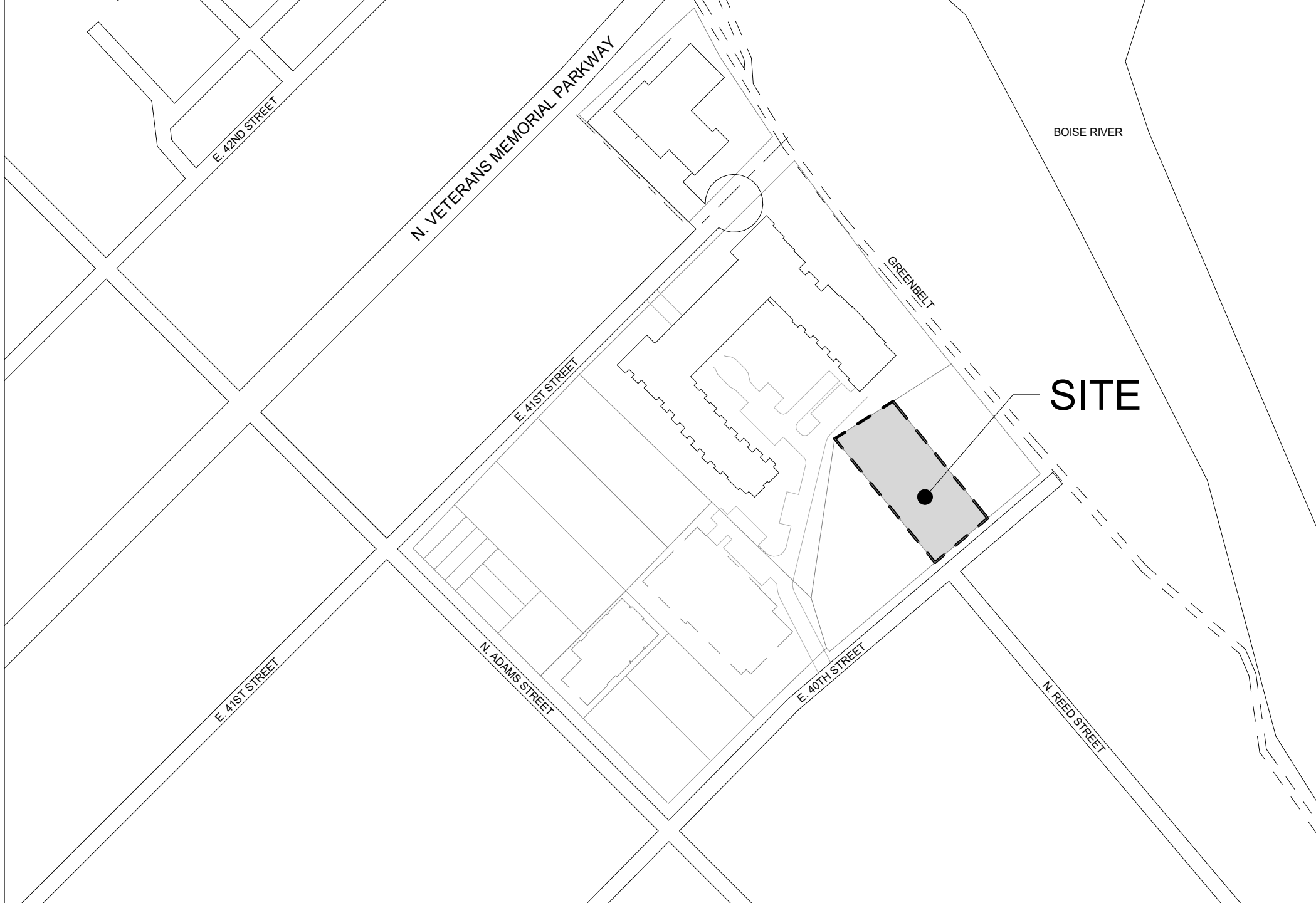

PROJECT TEAM

DEVELOPER Vida Properties 750 W Bannock St Suite 1743 Boise, ID 83702	ARCHITECT erstad ARCHITECTS Chad Weltzin 310 N. 5th Street Boise, ID 83702 208-331-9031	CIVIL Civil Site Works LLC Corinne Graham PO Box 6059 Boise, ID 83707 208-946-3874	LANDSCAPE Stack Rock Group Will Howard 404 S. 8th Street, #154 Boise, ID 83702 208-345-0500
--	---	--	---

SHEET LIST

A0.0	cover sheet + site plan
A0.1	neighborhood map
c1.0	site plan
c1.1	topo + demo plan
c2.0	grading + drainage plan
esc1.0	esc plan
L100	landscape notes & details
L101	landscape plan
L201	irrigation plan
L250	irrigation details



508 E 40th Street

REVISION STATEMENT

We have revised our architectural site plan to comply with the changes requested in the staff report, but are unable to update the Civil and Landscape drawings to match at this time. We will ensure these currently unchanged drawings are updated to match the conditions represented on sheet A0.0 for future permitting.

Thank you,

Courtney Matranga
erstad Architects